



# GARMENT DISPENSERS





## ASI STORAGE SOLUTIONS GARMENT DISPENSERS

When we set out to build ASI Storage Solutions Garment Dispensers, we had one simple goal in mind — make the most durable and innovative systems available to the market.

Utilizing the accumulated knowledge we have developed from many years of designing and manufacturing locker systems for school, commercial and general industrial use, we now present a complete line of lockers specifically for the Textile Rental Market.

Suitable for both uniform exchange and personal storage applications, these Garment Lockers offer durability, security, low-maintenance and ease-of-operation along with these distinctive features:

- Unique gravity-activated, multi-point locking system keeps compartment doors flush, making them resistant to pry-bar attacks
- 2 mil thick powder coating — that is two thirds thicker than competitive plated or painted surfaces — offers enhanced durability and resistance to rust
- Full-length piano hinge prevents racking and allows your route servicer to quickly unlock, re-stock and lock the unit



Available in two standard colors, all other colors are available upon request. Flat tops and Zee bases are standard; sloped tops, open bases and number-plates are available options.

## UNIQUE COMPARTMENT DOOR LOCKING SYSTEM

**Compartment  
Door Strike**

**Concealed Sliding  
Latch Mechanism**

**Strike Automatically  
Engages When Door  
is Closed**

**Key or  
Combination Lock**

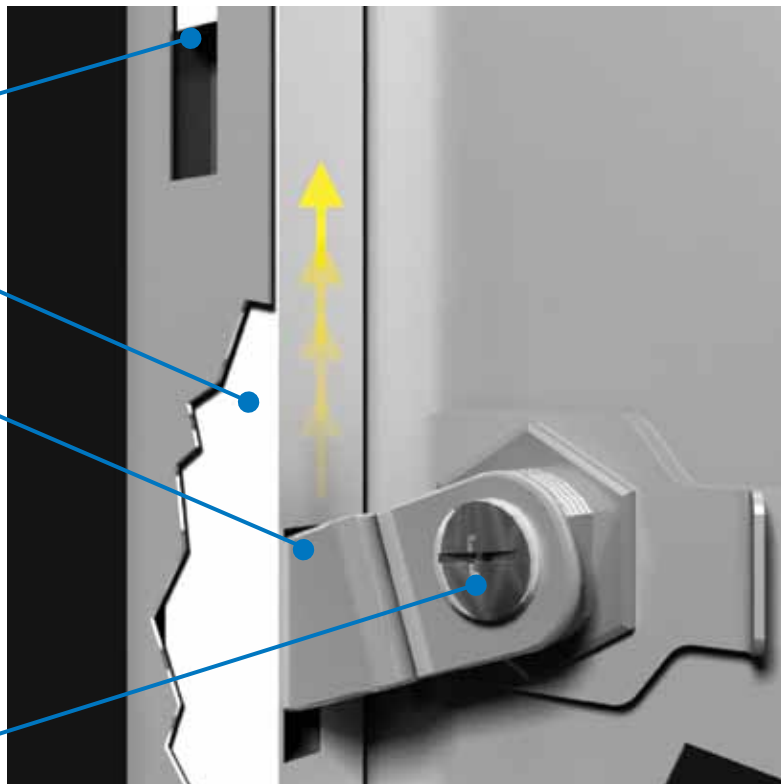



### **Heavier Steel**

The 16 gauge commercial grade steel we use to build our master doors makes them noticeably sturdier and heavier than others' typical 18 or 20 gauge.

### **Extra Thick Coating**

We don't paint. We 2 mil powder coat, which is as much as two-thirds thicker than competitive finishes, making them more durable and less likely to rust.

### **Total Master Door Hinging**

The full-length piano hinge evenly distributes the weight of the master door to assure easy operation and to help prevent contortion.

### **Unique Locking System**

Features gravity-activated, pry-resistant sliding locking mechanism — available keyed or latched for combination locks.

### **Economical Design**

Maximizes storage area while minimizing footprint.

### **Attractive Colors**

Powder Gray (shown) and Silver Grain standard; custom colors available.

### **Riveted Construction**

Assures durability, security and ease of operation.

# GARMENT LOCKERS

**3-Compartment Hanging:**  
26" x 21" x 42½"

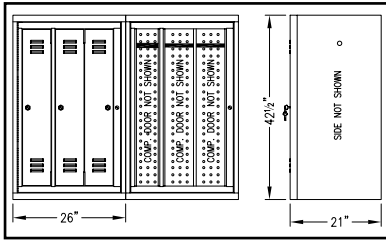

**4-Compartment Mini Hanging:**  
26" x 21" x 42"

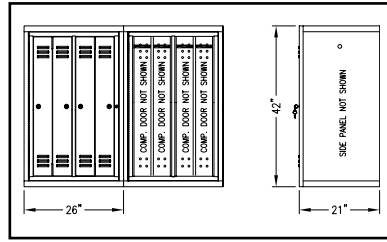

**4-Compartment Hanging:**  
26" x 21" x 84"

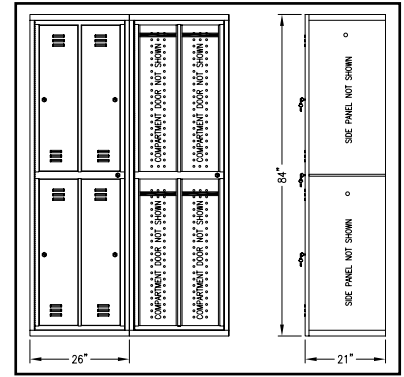

**8-Compartment Mini Folded:**  
17" x 16" x 39"

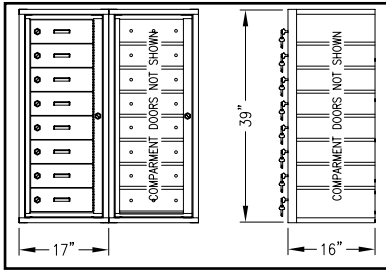

**8-Compartment Hanging:**  
26" x 21" x 84"

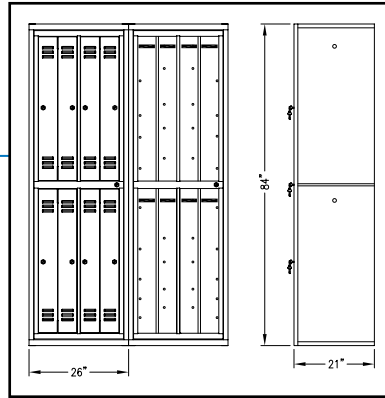

**8-Compartment Wide Hanging:**  
32½" x 21" x 84"

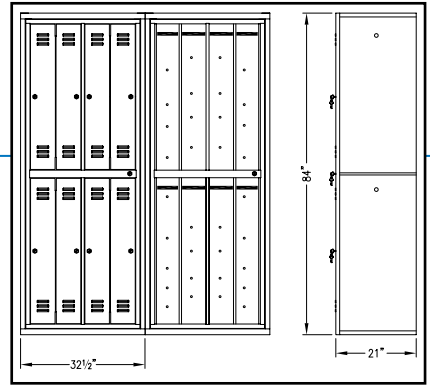

# LINEN EXCHANGE

**Linen Exchange:**  
26" x 21" x 84"

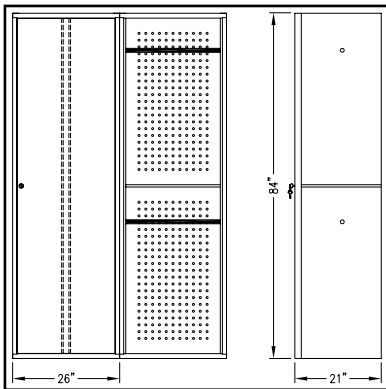

**Linen Exchange Wide:**  
32½" x 21" x 84"

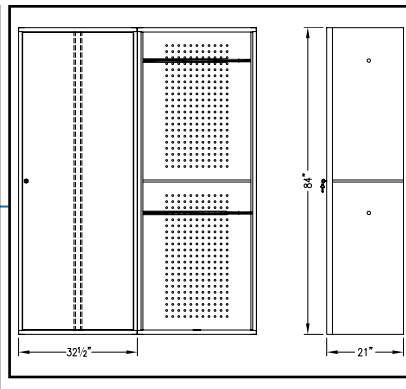

# SOILED GARMENT DISPOSAL

**Soiled Garment Disposal:**  
18" x 21" x 78"

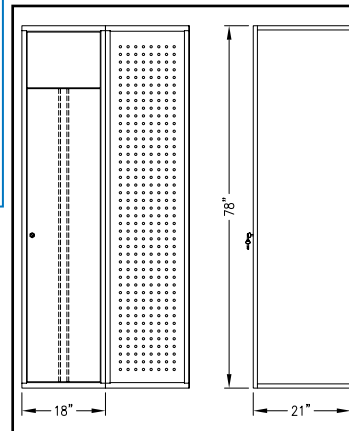

**Soiled Garment Disposal Wide:**  
26" x 21" x 84"

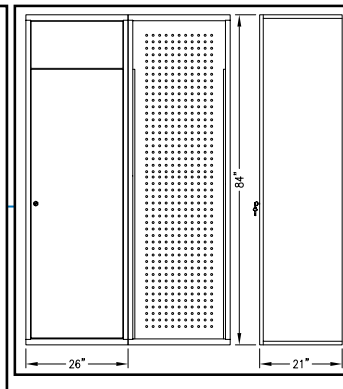

## GARMENT LOCKERS

**4-Compartment Long Hanging:**  
26" x 21" x 84"

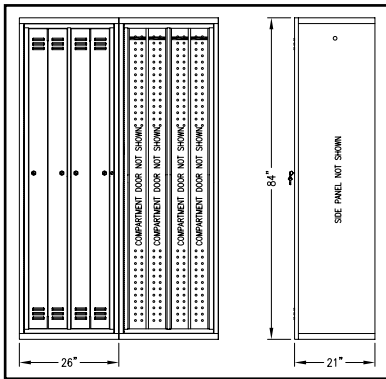

**5-Compartment Folded:**  
17" x 16" x 39"

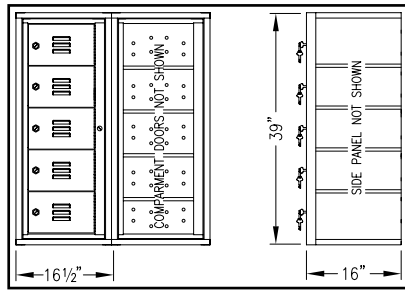

**6-Compartment Hanging:**  
26" x 21" x 84"

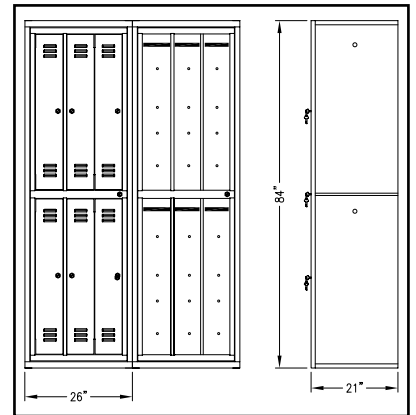

**9-Compartment Folded:**  
24" x 15" x 81"

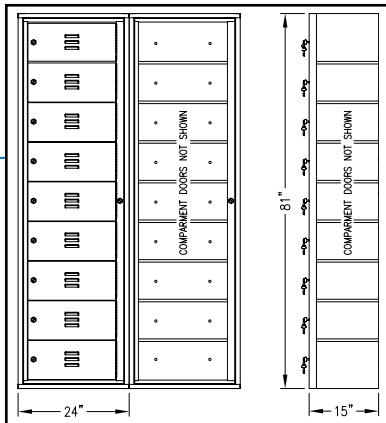

**10-Compartment Folded:**  
18" x 15" x 78"

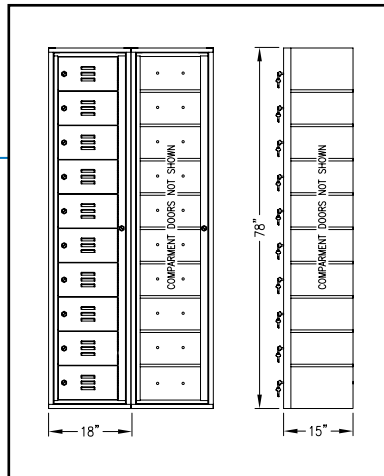

**16-Compartment Folded:**  
18" x 15" x 78"

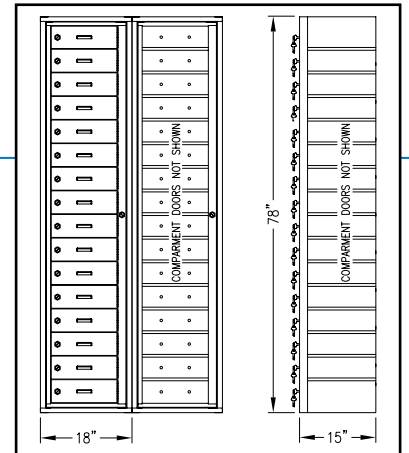

## SOILED GARMENT DISPOSAL

**Soiled Garment Disposal Double Tier:**  
26" x 21" x 84"

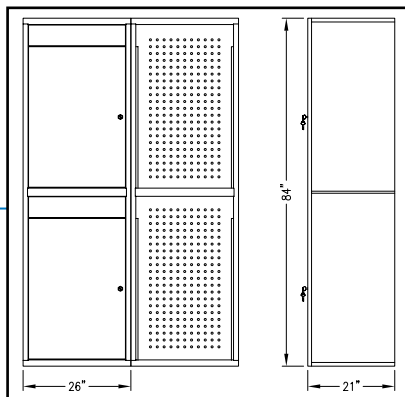

**Bulky Garment Disposal:**  
26" x 21" x 84"

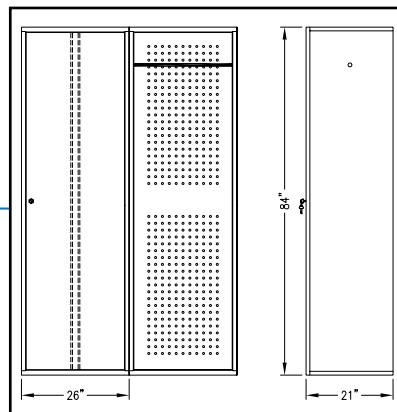

**Bulky Garment Disposal Wide:**  
32 1/2" x 21" x 84"

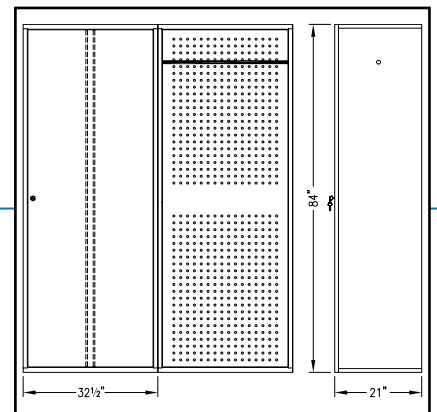

# GARMENT DISPENSERS

## OPTIONS



**Sloped Tops**



**Zee Bases**

Open base available.

## COLOR SELECTIONS

ASI Garment Dispensers are available in these 2 popular colors.

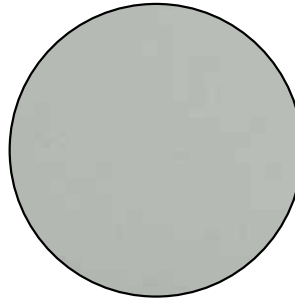

**Gray**  
#25

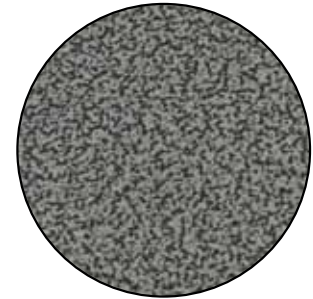

**Silver Grain**  
#24

Unlimited custom colors available upon request.



ASI Storage Solutions  
2171 Liberty Hill Road, Eastanollee, GA 30538  
Tel: 706.827.2701 Fax: 706.827.2710  
E-Mail: [info@asilockers.com](mailto:info@asilockers.com) Web: [asilockers.com](http://asilockers.com)